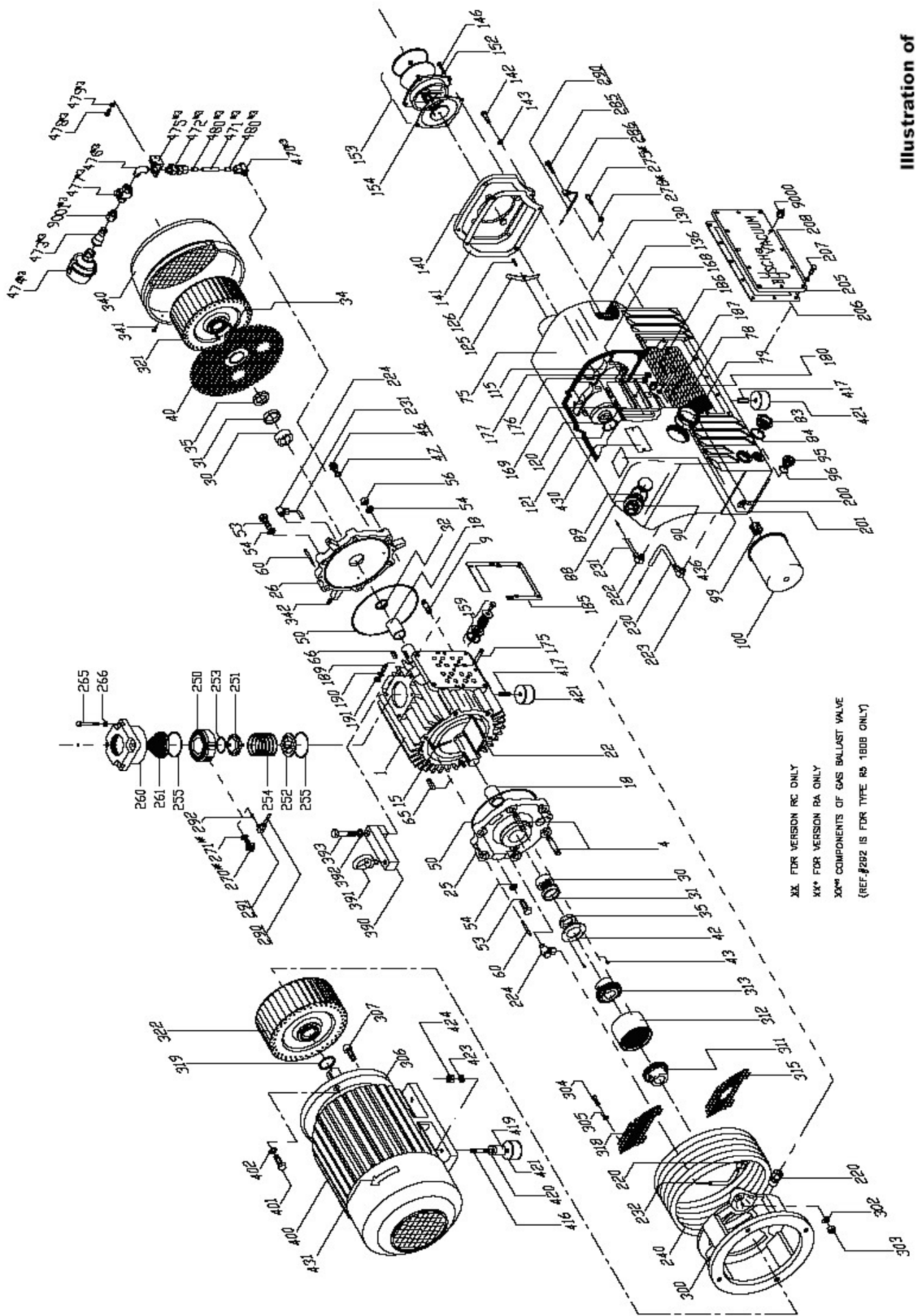

**Illustration of
R 5 0160 Series**



XX FOR VERSION RE ONLY
 XX* FOR VERSION RA ONLY
 XX** COMPONENTS OF GAS BALLAST VALVE
 (REF.#292 IS FOR TYPE R5 18DB ONLY)

Parts List for R 5 0160

Ref Description	Ref Description	Ref Description
001 Cylinder	176 Lockwasher	322 Motor side fan
004 Stud	177 Hex head nut	340 Fan Cover
009 Stud	180 Plug	341 Sheet metal screw
015 Rotor	185 Gasket	342 Plastic insert
018 Bearing sleeve	186 Hex head cap screw	390 Eyebolt adapter
022 Vane	187 Lockwasher	391 Eyebolt
025 Motor side endplate	189 Stud	392 Lockwasher
026 Opp. M.S. endplate	190 Lockwasher	393 Hex head cap screw
030 Needle bearing	191 Hex head nut	400 Motor
031 Endplate spacer	200 Drum exhaust box plug	401 Hex head cap screw
032 Pump spacer	201 O-ring	402 Lockwasher
034 Slotted chs hd cap screw	205 Cover side plate	416 Stud
035 Shaft seal	206 Gasket	417 Slotted set screw
040 Protective screen	207 Hex head cap screw	419 Foot spacer
042 Shaft seal retaining plate	208 Lockwasher	420 Flat washer
043 Hex head cap screw	220 Hydraulic fitting	421 Rubber foot
046 Hex head plug	222 Hydraulic fitting	423 Washer
047 Copper ring gasket	223 Hydraulic fitting	424 Hex head cap nut
050 O-ring	224 Hydraulic fitting	430 Nameplate
053 Hex head cap screw	230 Oil tubing	431 Arrow label
054 Lockwasher	231 Oil tubing	436 Maintenance label
056 Hex head cap nut	232 Oil tubing	470 Hydraulic fitting
060 Tapered pin	240 Cooling coil	471 Teflon tubing
065 Shaft key	250 Inlet flange	472 Check valve
066 Shaft key	251 Valve guide	473 Bell reducer
075 Exhaust box	252 Valve plate	474 Gas ballast filter
078 Sheet metal baffle	253 O-ring	475 Gas ballast valve bracket
079 Demister pad	254 Inlet check valve spring	476 Elbow fitting
083 Oil sight glass	255 O-ring	477 Pet cock valve
084 Ring gasket	260 Inlet flange	478 Hex head cap screw
088 Oil fill plug	261 Inlet screen	479 Lockwasher
089 Oil fill plug gasket	265 Hex head cap screw	480 Oil tube insert
090 Pressure gauge	266 Lockwasher	9000 Steel socket plug
095 Oil drain plug	270 Plug R1/8"	9001 Hydraulic adapter
096 O-ring	271 Ring gasket	
099 Nipple	275 Oil return valve	
100 Auto-type oil filter	276 Ring gasket	
115 Filter bracket	285 Oil recirc. screw	
120 Exhaust filter	286 Banjo hydraulic fitting	
121 O-ring	290 Oil return line tubing	
125 Filter spring assembly	291 Hydraulic fitting	
126 Socket head cap screw	292 Carburetor jet	
130 Baffle strainer	300 Motor mounting bracket	
136 Support for syn. frame	302 Lockwasher	
140 Exhaust cover plate	303 Hex shoulder nut	
141 Cover plate gasket	304 Socket hd machine screw	
142 Hex head cap screw	305 Flat washer	
143 Lockwasher	306 C-face adapter flange	
146 Hex head cap screw	307 Socket head screw	
152 Lockwasher	311 Motor side coupling half	
153 Exhaust silencer	312 Coupling insert	
154 Gasket	313 Pump side coupling half	
159 Exhaust valve	315 Protective screen	
168 O-ring	318 Protective screen	
169 Exh. valve cover plate	319 Spacer	
175 Stud	321 Pump shaft fan	