

# D-LAB DIAPHRAGM VACUUM PUMP

## PERFORMANCE YOU CAN RELY ON



D-LAB membrane pumps with their chemically resistant Teflon® heads, diaphragms and Kalrez® valves, offer the chemical or pharmaceutical laboratory user a wide range of choice.

The one head, 100 mbar ultimate vacuum pumps are suitable for use with drying equipment or for replacing water-jet pumps, whilst the two head, 8 mbar ultimate vacuum pumps are suitable for rotary evaporation, gas transfer and a wide range of medium vacuum applications.



### Features and Benefits

- **100% lubricant free**, maintenance free and quiet.
- **Six different pumping capacities** and modular expansion – the D-LAB can be optimised for any application.
- All parts of the pump head in contact with gases being pumped are **resistant against aggressive substances** (PTFE, FFKM, PVDF).

### Applications

- Rotary evaporation.
- Gel drying.
- Vacuum desiccation.
- Vacuum filtration.
- Vacuum degassing.

### Pump Range

#### D-LAB

- D-LAB 10-100
- D-LAB 20-100
- D-LAB 34-100
- D-LAB 10-8
- D-LAB 20-8
- D-LAB 34-8



# Performance Curves

## D-LAB Diaphragm vacuum pump

### D-LAB



Pumping speed (air)	
10-100, 10-8	0.6 m <sup>3</sup> h <sup>-1</sup> , 10 lmin <sup>-1</sup>
20-100, 20-8	1.2 m <sup>3</sup> h <sup>-1</sup> , 20 lmin <sup>-1</sup>
34-100, 34-8	2.0 m <sup>3</sup> h <sup>-1</sup> , 34 lmin <sup>-1</sup>
Ultimate vacuum, 50 Hz (60 Hz)	
10-100,	100 mbar
20-100, 34-100	(75 mbar)
10-8, 20-8, 34-8	8 mbar (6 mbar)

110 V pumps are supplied with USA plug; 220-240 V pumps are supplied with an IEC connector but mains cable with correct plug must be ordered separately.

### Ordering information

Product description	Order no:
D-LAB 10-100, diaphragm pump, 110 V, 60 Hz, 1-ph	A48015941
D-LAB 10-100, diaphragm pump, 220-240 V, 50 Hz, 1-ph	A48015960
D-LAB 20-100, diaphragm pump, 110 V, 60 Hz, 1-ph	A48017941
D-LAB 20-100, diaphragm pump, 220-240 V, 50 Hz, 1-ph	A48017960
D-LAB 34-100, diaphragm pump, 110 V, 60 Hz, 1-ph	A48021941
D-LAB 34-100, diaphragm pump, 220-240 V, 50 Hz, 1-ph	A48021960
D-LAB 10-8, diaphragm pump, 110 V, 60 Hz, 1-ph	A48016941
D-LAB 10-8, diaphragm pump, 220-240 V, 50 Hz, 1-ph	A48016960
D-Lab 20-8, diaphragm pump, 110 V, 60 Hz, 1-ph	A48018941
D-Lab 20-8, diaphragm pump, 220-240 V, 50 Hz, 1-ph	A48018960
D-LAB 34-8, diaphragm pump, 110 V, 60 Hz, 1-ph	A48022941
D-LAB 34-8, diaphragm pump, 220-240 V, 50 Hz, 1-ph	A48022960

### D-LAB Performance Curve

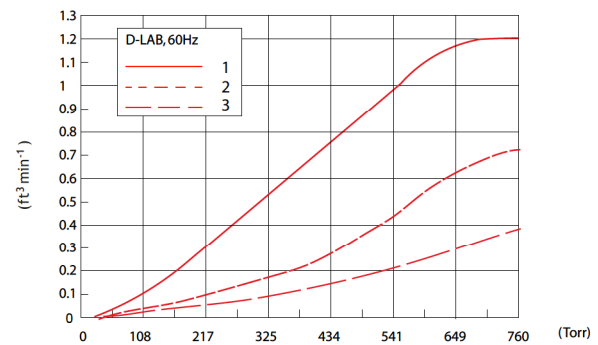
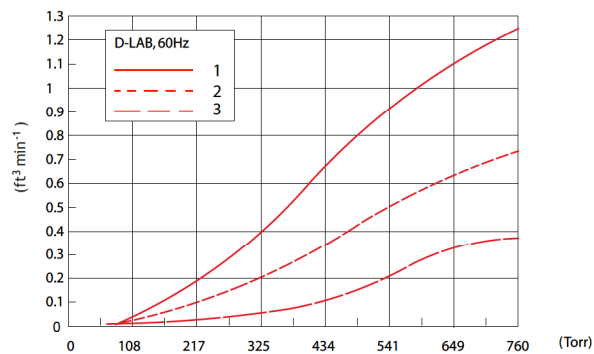
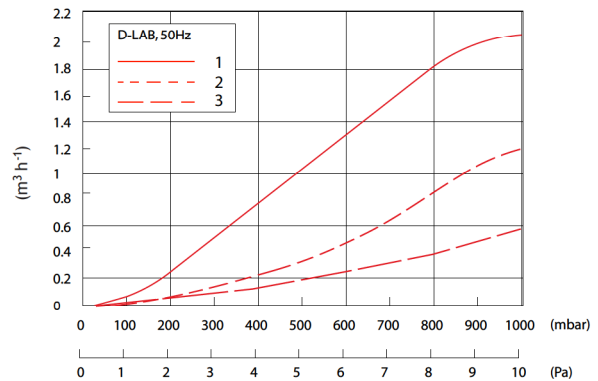
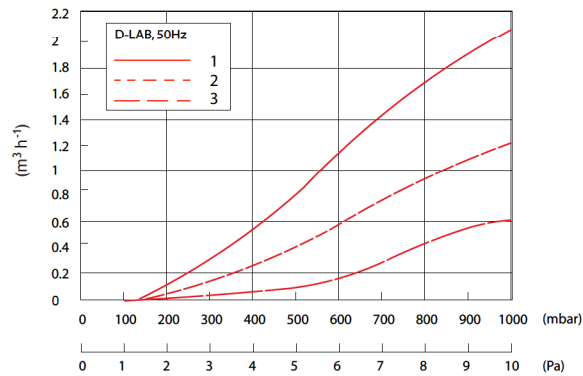

1	D-LAB 34-100
2	D-LAB 20-100
3	D-LAB 10-100

1	D-LAB 34-8
2	D-LAB 20-8
3	D-LAB 10-8

# Dimensions

## DLAB dimensions

One head pump

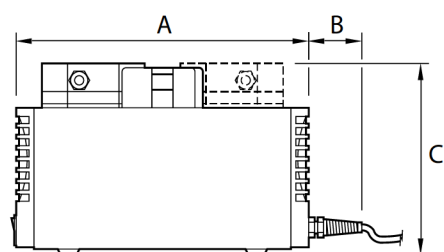
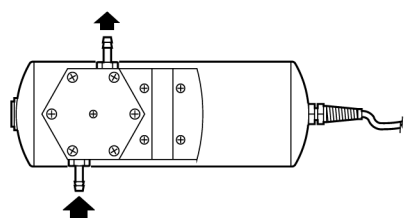
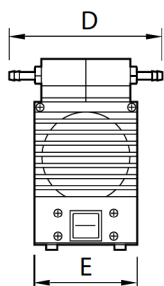

Two head pump

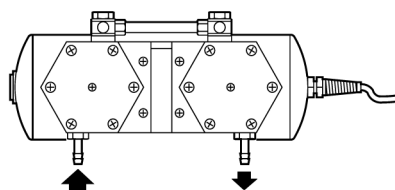
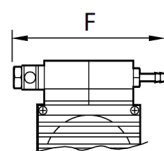

	A	B	C	D	E	F
10-100	255	50	182	144	98	-
20-100	268	60	204	157	110	-
34-100	296	60	222	172	122	-
10-8	288	53	184	-	98	140
20-8	312	59	204	-	110	153
34-8	341	62	222	-	122	169



# Technical Data



	Units	D-LAB
<b>Pumping speed (air)</b>		
10-100, 10-8	m <sup>3</sup> h <sup>-1</sup> / lmin <sup>-1</sup>	0.6 / 10
20-100, 20-8	m <sup>3</sup> h <sup>-1</sup> / lmin <sup>-1</sup>	1.2 / 20
34-100, 34-8	m <sup>3</sup> h <sup>-1</sup> / lmin <sup>-1</sup>	2 / 34
<b>Ultimate vacuum</b>		
10-100, 20-100, 34-100	mbar, Hz / mbar, Hz	100, 50 / 75, 60
10-8, 20-8, 34-8	mbar, Hz / mbar, Hz	8, 50 / 6, 60
<b>Inlet and outlet connection</b>		Riffled nozzle, suitable for 9 mm i.d. hose
<b>Maximum inlet pressure</b>	bar	1
<b>Motor power and current</b>		
10-100, 110 V 60 Hz	W / A	110 / 1.3
10-100, 220-240 V 50Hz	W / A	100 / 0.6
20-100, 110 V 60 Hz	W / A	145 / 1.9
20-100, 220-240 V 50Hz	W / A	130 / 0.9
34-100, 110 V 60 Hz	W / A	220 / 3.2
34-100, 220-240 V 50Hz	W / A	180 / 1.4
10-8, 100 V 60 Hz	W / A	110 / 1.3
10-8, 220-240 V 50Hz	W / A	90 / 0.6
20-8, 110 V 60 Hz	W / A	130 / 1.2
20-8, 220-240 V 50Hz	W / A	120 / 0.9
34-8, 110 V 60 Hz	W / A	250 / 3.2
34-8, 220-240 V 50 Hz	W / A	200 / 1.5
<b>Enclosure rating</b>		IP44
<b>Operating temperature</b>	°C	5-40
<b>Weight</b>		
10-100	kg / lbs	5.8 / 12.8
20-100	kg / lbs	7.1 / 15.6
34-100	kg / lbs	10.3 / 22.7
10-8	kg / lbs	6.9 / 15.2
20-8	kg / lbs	9.3 / 20.5
34-8	kg / lbs	12.6 / 27.7

# Service, Spares and Accessories

## D-LAB Accessories

Product description	Order no:
D-LAB Controller 230 V	A48015138
D-LAB Controller 100/110 V	A48015139
D-LAB Baseplate 10+20-x	A48015134
Baseplate for D-LAB pumps 34-100, 34-8	A48021134
D-LAB Separator	A48015136
D-LAB Condenser	A48015137
Gas Ballast for D-LAB pumps 10-100, 10-8	A48015135
Gas Ballast for D-LAB pumps 20+34-8	A48017135

## Electrical Supply Cable

Product description	Order no:
2 m electrical supply cable for 1-ph pumps, UK, three-pin plug	A50505000
2 m electrical supply cable for 1-ph pumps, North European plug	A50506000
2 m electrical supply cable for 1-ph pumps, no plug	A50508000

## Service kits

Product description	Order no:
Service kit for D-LAB 10-100	A48015815
Service kit for D-LAB 20-100	A48017815
Service kit for D-LAB 34-100	A48021815
Service kit for D-LAB 10-8	A48016815
Service kit for D-LAB 20-8	A48018815
Service kit for D-LAB 34-8	A48022815

## Service

Edwards products, spares and accessories are available from Edwards companies in Belgium, Brazil, China, France, Germany, Israel, Italy, Japan, Korea, Singapore, United Kingdom, U.S.A. and a worldwide network of distributors. The majority of these centres employ Service Engineers who have undergone comprehensive Edwards training courses. Order spare parts and accessories from your nearest Edwards company or distributor.

When you order, please state for each part required:

- Model and item number of your equipment.
- Serial number (if any).
- Item number and description of the part.

